

# **Paddock logistics**

**Important information for  
all competitors.**



**Silverstone GP – August 16/17 2014**

**Issue ONE**

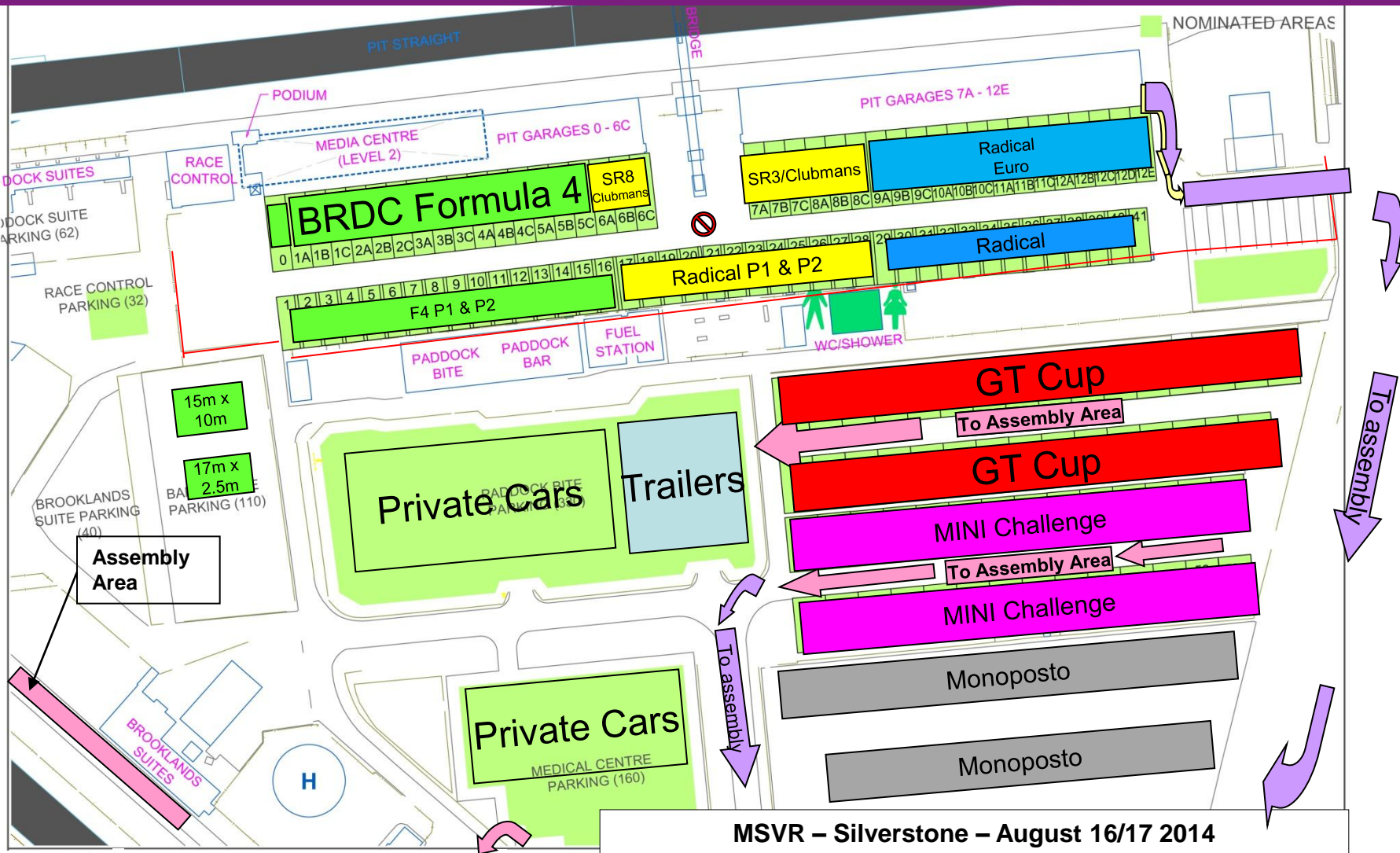

MSVR – Silverstone – August 16/17 2014

Route to Assembly Area for all categories based in pit garages

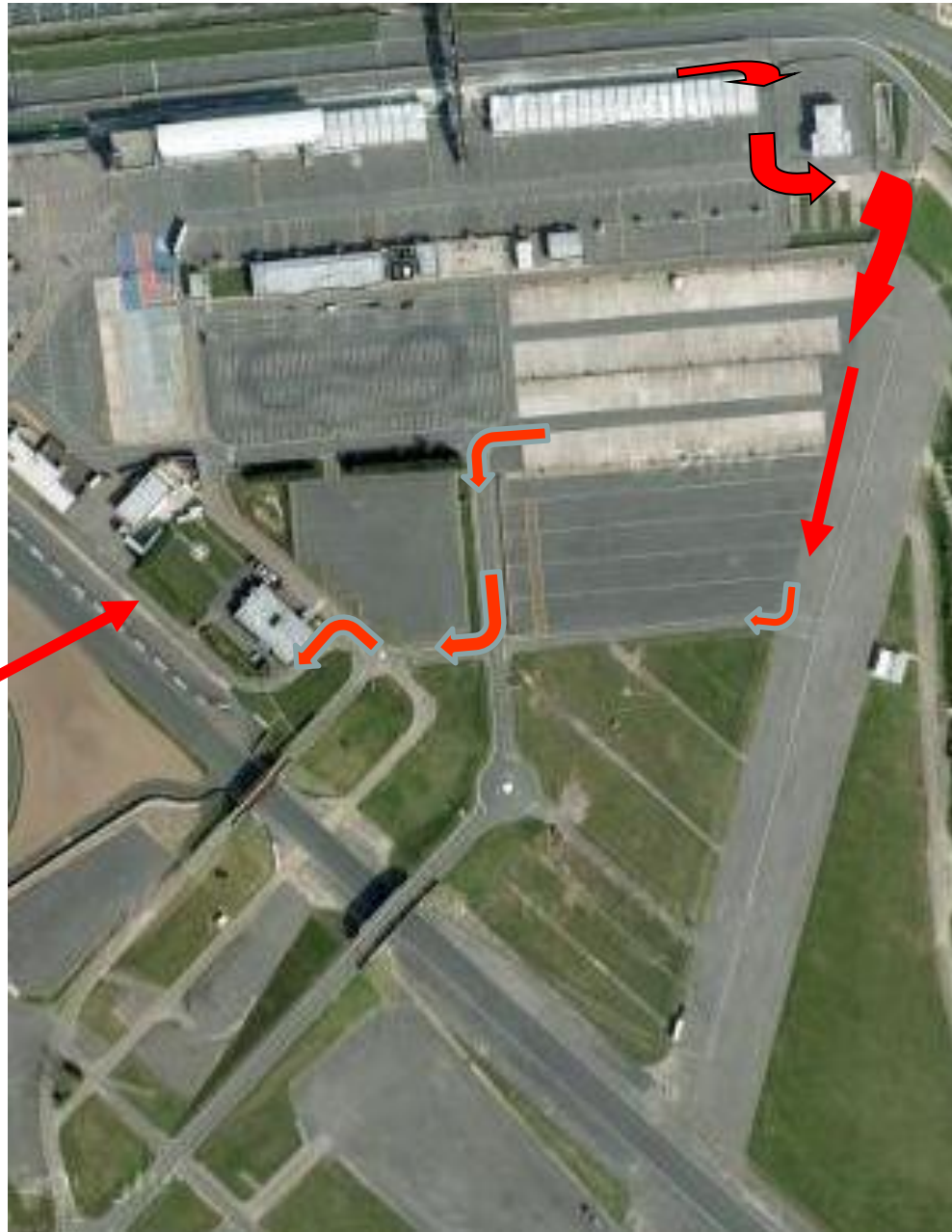

Assembly Area



**MAX  
SPEED  
20 mph**

MSVR – Silverstone  
August 16/17 2014

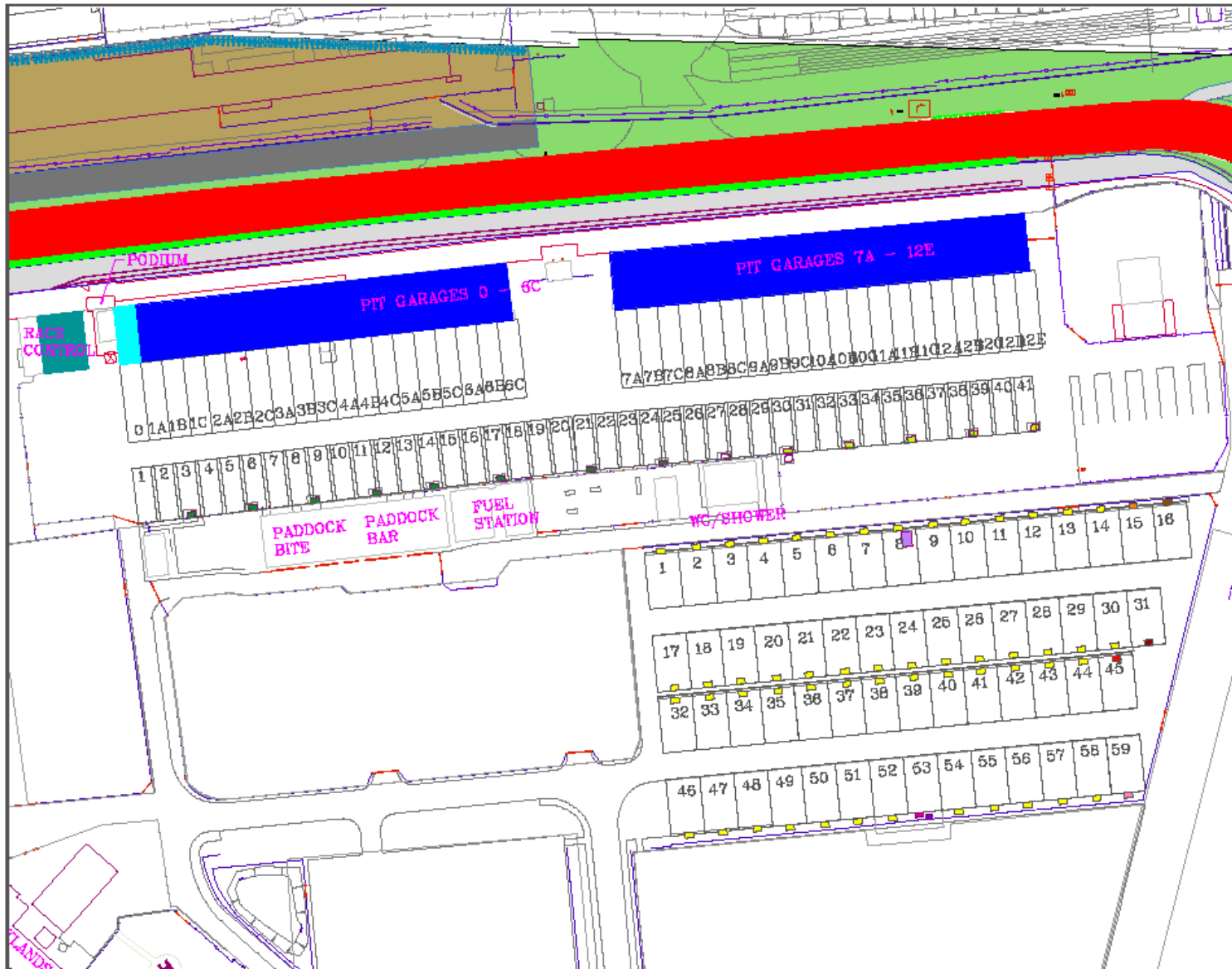

- PIT GARAGES  
1A, 2C, 3A, 4C, 5A, 6C, 7A, 8C, 9A,  
10C, 11A, 12C, 12D  
REAR:  
6X 18AMP C-FORM SINGLE PHASE  
3X 18AMP TWIN SOCKETS  
3X 32AMP C-FORM THREE PHASE  
FRONT  
4X 18AMP C-FORM SINGLE PHASE
- PIT GARAGE 0  
4X 28AMP C-FORM THREE PHASE  
1X 32AMP C-FORM THREE PHASE
- DOUBLE GARAGE UNDER RACE CONTROL  
2X 32AMP C-FORM THREE PHASE  
2X 63AMP C-FORM THREE PHASE  
6X 18AMP C-FORM SINGLE PHASE
- PIT WALL  
OUTSIDE PIT GARAGES, F1 START/FINISH,  
NATIONAL FINISH  
40X 18AMP C-FORM THREE PHASE
- MAIN PADDOCK  
EACH POD NOS 1-8  
6X 18AMP C-FORM SINGLE PHASE  
6X 32AMP C-FORM THREE PHASE
- MAIN PADDOCK  
EACH POD NOS 9-14  
4X 18AMP C-FORM SINGLE PHASE  
4X 32AMP C-FORM THREE PHASE
- SUPPORT PADDOCK  
1X 18AMP C-FORM THREE PHASE
- SUPPORT PADDOCK BAY 15  
2X 28AMP C-FORM THREE PHASE
- SUPPORT PADDOCK BAY 18  
2X 32AMP C-FORM THREE PHASE  
1X 18AMP C-FORM THREE PHASE
- SUPPORT PADDOCK BAY 31  
2X 32AMP C-FORM THREE PHASE  
2X 18AMP C-FORM THREE PHASE  
1X 32AMP C-FORM SINGLE PHASE
- SUPPORT PADDOCK BAY 45  
2X 18AMP C-FORM THREE PHASE
- SUPPORT PADDOCK BAY 63  
1X 18AMP C-FORM SINGLE PHASE  
1X 32AMP C-FORM SINGLE PHASE
- SUPPORT PADDOCK BAY 69  
2X 32AMP C-FORM THREE PHASE  
1X 18AMP C-FORM THREE PHASE
- SUB STATION  
TOP OF SUPPORT PADDOCK  
2X 125AMP C-FORM THREE PHASE
- SUB STATION  
BOTTOM OF SUPPORT PADDOCK  
1X 18AMP C-FORM SINGLE PHASE  
1X 32AMP C-FORM SINGLE PHASE



**EVENT PLAN**  
 REVISION NUMBER: 1      DATE: 16 MARCH 2010  
 CREATED BY: A O'BRIEN

**Paddock POWER PLAN**  
**2010**

© 2010. THIS DRAWING IS THE PROPERTY OF SILVERSTONE CIRCUITS LIMITED. DO NOT DUPLICATE OR ISSUE WITHOUT THE PRIOR PERMISSION FROM SILVERSTONE CIRCUITS LIMITED. DO NOT SCALE. CHECK ALL DIMENSIONS ON SITE BEFORE COMMENCING ANY WORK. IF IN DOUBT - ASK.

